

STREET WRAP™ FLEX MINI

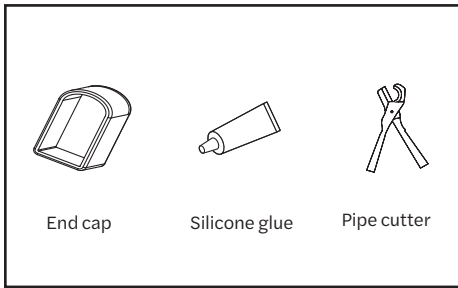

Cutting and Sealing



Installation tools & components

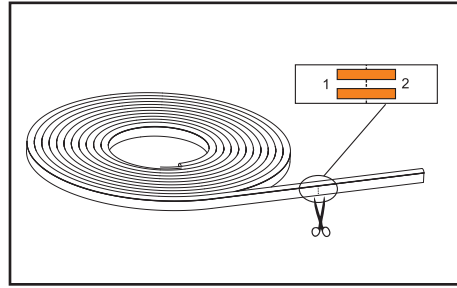

1. Cut on designated cut mark.

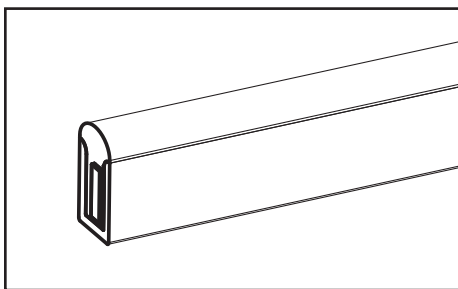

2. Clean cut end before next steps.

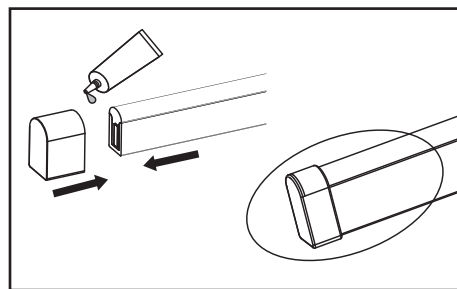

3. Coat end cap with silicone glue and install.

CAUTION

Do **NOT** twist and bend this product abruptly or severely.



This action may cause copper trace or solder connections to crack, resulting in section outages along the strand.

TAKE EXTREME CAUTION WHEN UNBOXING AND INSTALLING.

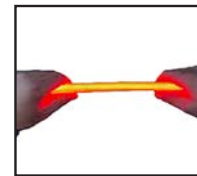

Normal flex



Unnatural bend



Section outage



Result of twist & bend

Outages caused by these actions may void your warranty.

Unwind Flex strip from coil or reel carefully and without twisting.

STREET WRAP™ FLEX MINI



Installation Street Wrap Flex Mini can be mounted to any surface that will accommodate conventional fasteners.

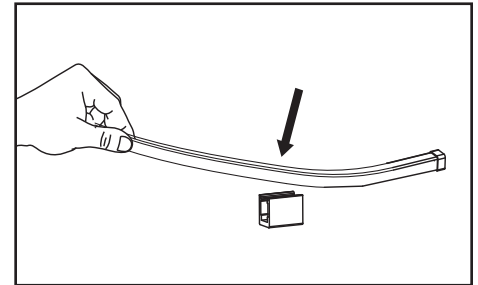
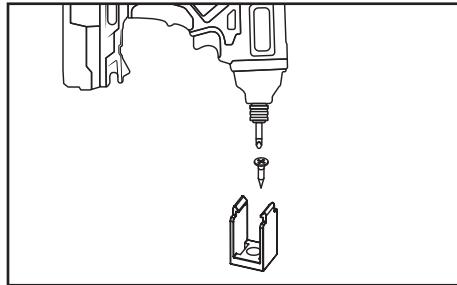
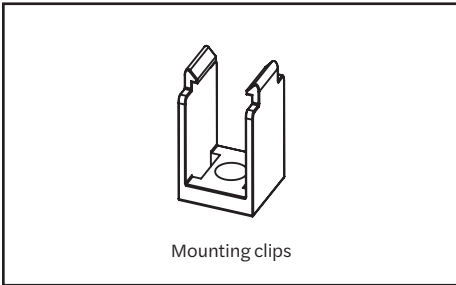

Mounting Accessories

1. Place mounting clips wherever necessary to shape **Street Wrap Flex Mini** to desired contour. Fasten clips to mounting surface using #4 pan head screws or 0.125" rivets.

2. Gently press product into mounted clips.

Warnings

Lighting surface

Street Wrap Flex Mini only bends as shown above.

Do not pull on or hold product by cable.

Do not twist or bend product at sharp angles.

TOP VIEW

SIDE VIEW

Mounting surface

For assembly of Street Wrap Flex Mini longer than 6.6 ft:
Careful handling with a minimum of two (2) employees is required.

Customer service and technical support

- principalsloan.com
- 325.227.4577
- 3490 Venture Dr., San Angelo, TX 76905

